

Europa 1/Europa 2

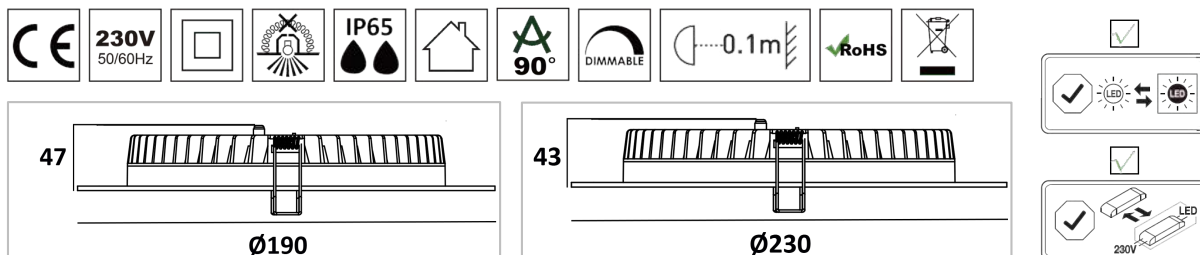

IMPORTANT INFORMATION:

1. Please read this instruction carefully before installation and keep it for future reference.
2. Please conform to the instruction of equipment and installed by professional.
3. Make sure correct voltage applied before use and keep away from heat and vibration source.
4. The light source of this luminaire is not replaceable. When the light source reaches its end of life the whole luminaire shall be replaced.
5. The product is not suitable for any oil pollution ambient or related applications.
6. This product contains a light source of energy efficiency class **D**.
7. It shall not be disposed of as unsorted municipal waste.
8. For indoor use only or under shelter for outdoor use.

MAIN PARAMETER:

Product	Europa 1 DIM 241504	Europa 1 DALI 241514	Europa 2 DIM 242504	Europa 2 DALI 242514
Rated Voltage	220-240V 50/60Hz	AC 220-240V 50/60Hz	AC 220-240V 50/60Hz	AC 220-240V 50/60Hz
LED watt	15W	15W	25W	25W
System eff	17W	17W	26W	26W
LED	Bridgelux SMD LED	Bridgelux SMD LED	Bridgelux SMD LED	Bridgelux SMD LED
LED Driver	Constant Current 450mA	Constant Current 450mA	Constant Current 700mA	Constant Current 700mA
Color Temperature	3000K	3000K	3000K	3000K
Protection	Class II	Class II	Class II	Class II
Beam Angle	90°	90°	90°	90°
IP Rated	IP65	IP65	IP65	IP65
Operation Temperature	-25°C <ta<45°C	-25°C <ta<45°C	-25°C <ta<45°C	-25°C <ta<45°C
Cut-out	Ø170-180mm	Ø170-180mm	Ø180-220mm	Ø180-220mm
Product Size	Ø190mmxH47mm	Ø190mmxH47mm	Ø230mmxH43mm	Ø230mmxH43mm

INSTALLATION INSTRUCTIONS:

1. Always switch off the power supply before installation.
2. Make sure all parts are ready when open the box and prepare the installation tools the lighting needs.
3. Should be installed by qualified electricians.
4. If there is any damage on the housing or glass cover, should view it as disqualified product that cannot be used.
5. If the external flexible cable or cord of this luminaire is damaged, it shall be exclusively replaced by the manufacturer or his service agent or a similar qualified person in order to avoid a hazard.

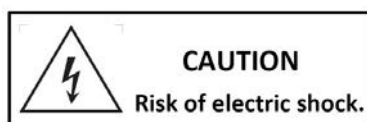
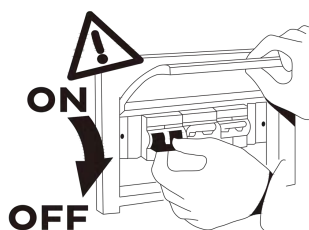

INSTALLATION STEPS:

1. Cut-out for the downlight.

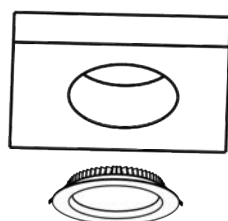

Europa 1
article: 241504/241514
Cut-out: Ø170-180mm

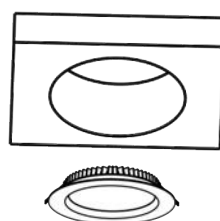

Europa 2
article: 242504/242514
Cut-out: Ø185-215mm

2. This luminaire is pre-wired with 1,5m cable and Euro plug for connection to the Mains supply. Slide the mounting spring clips into the ceiling cut-out and push the luminaire up into cutting hole. Ensure that it is securely located.

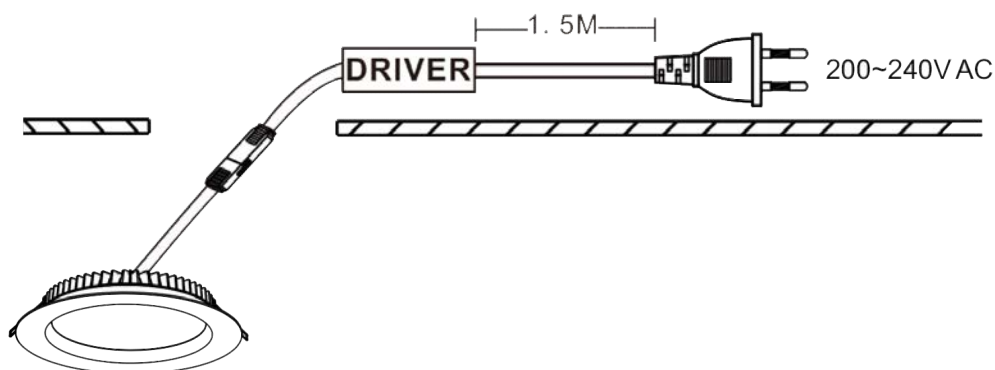

3. Switch on the power supply.

